

# Agmate<sup>®</sup> Rolling Cultivator Spiders



## 4 Gang Complete Assemblies

Part #	Description	Weight
49441	14-1/2" 4 Gang Assembly Complete (Left Hand) (#2)	60 lbs.
49442	14-1/2" 4 Gang Assembly Complete (Right Hand) (#1)	60 lbs.
49445	16" 4 Gang Assembly Complete (Left Hand) (#2)	68.3 lbs.
49446	16" 4 Gang Assembly Complete (Right Hand) (#1)	68.3 lbs.



## 5 Gang Complete Assemblies

Part #	Description	Weight
49443	14-1/2" 5 Gang Assembly Complete (Left Hand) (#2)	70 lbs.
49444	14-1/2" 5 Gang Assembly Complete (Right Hand) (#1)	70 lbs.
49447	16" 5 Gang Assembly Complete (Left Hand) (#2)	79 lbs.
49448	16" 5 Gang Assembly Complete (Right Hand) (#1)	79 lbs.

## Spider Wheels

Ref #	Part #	Description	Weight
1	25937	14-1/2" Spider Wheel (Left Hand) (#2)	8.75 lbs.
1	25938	14-1/2" Spider Wheel (Right Hand) (#1)	8.75 lbs.
1	34651	16" Spider Wheel (Left Hand) (#2)	10.5 lbs.
1	34652	16" Spider Wheel (Right Hand) (#1)	10.5 lbs.

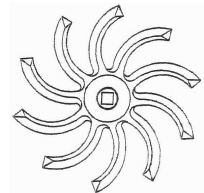

## Components (Fasteners available upon request)

Ref #	Part #	Description
2	34643	Scraper Assembly for 14-1/2" to 16" (heat treated)
3	28188	4 Gang Axle 15/16" x 18.25"
3	28209	5 Gang Axle 15/16" x 21.5"
	29799	Inner Rear Seal Guard
4	29800	Inner Seal Guard (takes 2)
	29801	Outer Seal Guard
5	32629	205PPB7/BCA#205TTH Bearing
6	17972	Flange (takes 4)

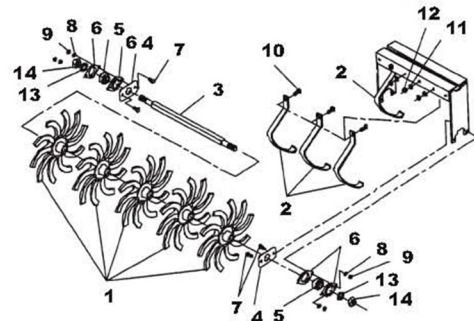

## Single Direction Spider Wheel- 4 Gang Complete Assembly

Part #	Description
84756	15" 4 Gang Assembly Complete

## Single Direction Spider Wheel- 5 Gang Complete Assembly

Part #	Description
84757	15" 5 Gang Assembly Complete

## Single Direction Spider Wheel

Part #	Description	Material
75765	15" Single Direction Spider Wheel	Ductile iron 80-55-06

