

# Bale Spears - Conus 1

Grizzly®



Special Order Sizes Available Upon Request

## Tapered Bale Spears w/ Nut



Part #	Overall	Usable	Diameter	Color	Brand	Max Load
#81328	24"	19"	36 mm	Black	bpt®	1,870 lb.

Bushing sold separate

## Ribbed Bale Spears w/ Nut

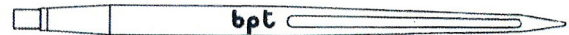

Part #	Overall	Usable	Diameter	Color	Brand	Max Load
#70187	32"	27"	38 mm	Black	bpt®	1,870 lb.
#49664	39"	34"	36 mm	Black	bpt®	1,870 lb.
#49665	43"	38"	36 mm	Black	bpt®	1,870 lb.

Bushing sold separate

## Cranked Tine

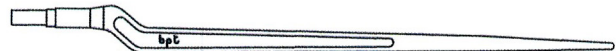

Part #	Overall	Usable	Diameter	Color	Brand	Max Load
#79258	36"	26"	36 mm	Red	bpt®	1,870 lb.

Bushing sold separate

## Curved Tine



Part #	Overall	Usable	Diameter	Color	Brand	Max Load
#86925	24"	18"	36 mm	Black	bpt®	1,870 lb.

Bushing sold separate

## Bushings / Sleeves

Part #	Brand	A	B	Fits Bale Spear #
#81329	bpt®	110 mm	45 mm	#81328 & #79258
#58928	bpt®	110 mm	45 mm	#70187
#49666	bpt®	145 mm	51 mm	#49664 & #49665
#102192	Grizzly®	145 mm	51 mm	#49664 & #49665
#86926	bpt®	110 mm	45 mm	#86925

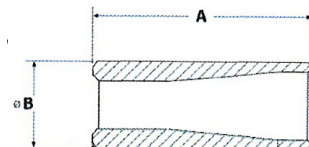

## Replacement Nuts



Part #	Fits Bale Spear #	Specs
#81330	#81328	M20 x 1.5
#52028	#70187, #49664 & #49665	M22 x 1.5
#84914	#79258	M24 x 1.5

# Bale Spears - Conus 2 & 3 Grizzly®



Special Order Sizes Available Upon Request

## Tapered Bale Spears w/ Nut



Part #	Overall	Usable	Diameter	Color	Brand	Max Load
#61413	32"	27"	45 mm	Black	bpt®	3,500 lb.
#61414	39"	33"	45 mm	Black	bpt®	3,500 lb.
#83120	43"	38"	45 mm	Black	bpt®	3,500 lb.
#49601	49"	44"	45 mm	Black	Grizzly®	3,200 lb.
#44119	49"	44"	45 mm	Black	bpt®	3,200 lb.
#77880	49"	44"	50 mm	Black	bpt®	4,800 lb.

Bushing sold separate

## Ribbed Bale Spears w/ Nuts

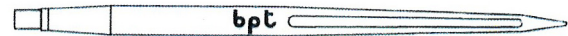

Part #	Overall	Usable	Diameter	Color	Brand	Max Load
#53724	43"	38"	42 mm	Black	bpt®	3,234 lb.
#82554	47"	42"	42 mm	Black	bpt®	3,234 lb.

Bushing sold separate

## "Bolt On" Bale Spears

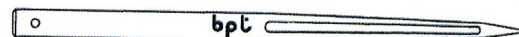

Part #	Overall	Usable	Diameter	Bolt Diameter	Color	Brand	Max Load
#69122	32"	27"	42 mm	14 mm pin hole	Black	bpt®	3,234 lb.
#49667	47"	42"	42 mm	12 mm pin hole	Black	bpt®	3,234 lb.
#109180	49"	44"	45 mm	12 mm pin hole	Black	bpt®	3,500 lb.

Bushing sold separate

## Bushings / Sleeves

Part #	Brand	A	B	Pin Hole	Fits Bale Spear #
#49668	bpt®	150 mm	60 mm	13 mm	#69122 & #49667
#86407	Grizzly®	150 mm	60 mm	13 mm	#69122 & #49667
#53725	bpt®	145 mm	57 mm	Tapered	#53724 & #82554
#44132	bpt®	145 mm	60 mm	Tapered	All Agmate 45 mm Spears
#84130	Grizzly®	145 mm	60 mm	Tapered	All Agmate 45 mm Spears
#85859	Grizzly®	111 mm	50.8 mm	Tapered	All Agmate 45 mm Spears
#77881	bpt®	170 mm	70 mm	Tapered	#77880
#110784	bpt®	150 mm	60 mm	13 mm	#109180

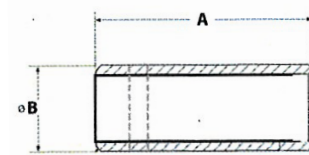

"Bolt on" Style

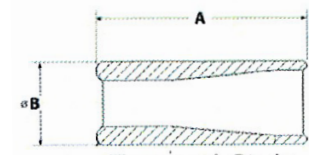

Tapered Style

## Replacement Nuts



Part #	Fits Bale Spear #	Specs
#52029	All 42 mm - 50 mm bpt® Spears	M28 x 1.5
#77853	#49601	M30 x 2

# Bale Spears

Special Order Sizes Available Upon Request

## Grizzly® Stabilizer Spears



Part #	Overall	Diameter	Bolt Diameter	Brand	Material
#106672	18.25"	1.25"	5/16" pin hole	Grizzly®	C1045
#106673	20"	1.50"	5/16" pin hole	Grizzly®	C1045

Bushing not available for #106673



Part #	Overall	Diameter	Bolt Diameter	Brand	Material
#111484	17"	1.25"	5/16" pin hole	Grizzly®	C1045 C.R.-Zinc Plated

Bushing sold separate

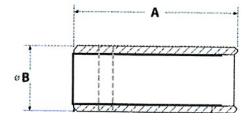

## Bushing / Sleeves

Part #	Brand	A	B	Pin Hole	Fits Bale Spear #
#85858	Grizzly®	73 mm	44 mm	5/16"	#85857
#111485	Grizzly®	73 mm	44 mm	5/16"	#111484 & 106622

## Agmate® Hay Grapple Hook

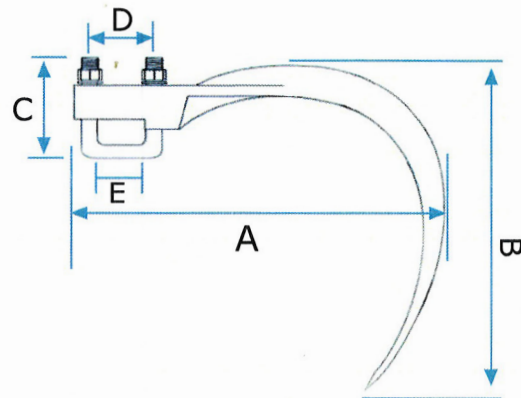

Part #	Description	A	B	C	D	E
#68279	Small Hay Hook with U-Bolt Kit	9"	9"	3"	1-5/8"	1-1/4"
#89071	Small Hay Hook without U-Bolt Kit	9"	9"	3"	1-5/8"	1-1/4"
#101468	Large Hay Hook with U-Bolt Kit	11"	12-1/4"	2-7/8"	2-1/16"	1-1/2"



Part #	Description
#72794	Replacement U-Bolt Kit for Small Hay Hook ( U-Bolt, 2 Lock Washers, 2 Nuts)
#104329	Replacement U-Bolt Kit for Large Hay Hook (U-Bolt, 2 Lock Washes, 2-Nuts)